



The Prescott

T W O B E D R O O M H O U S E



The Prescott

757 SQ FT | TWO BEDROOM HOUSE

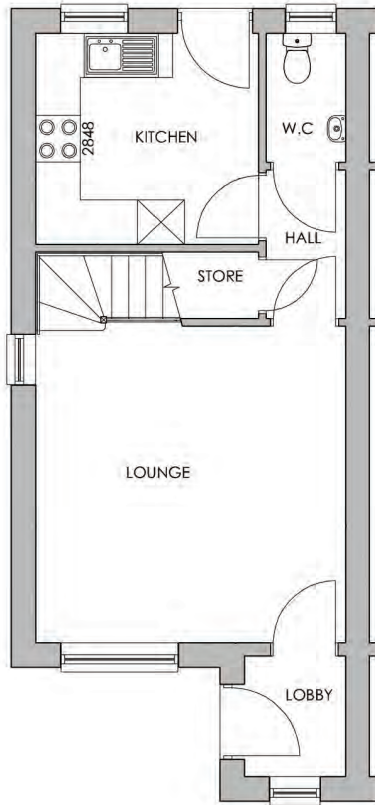

Ground Floor

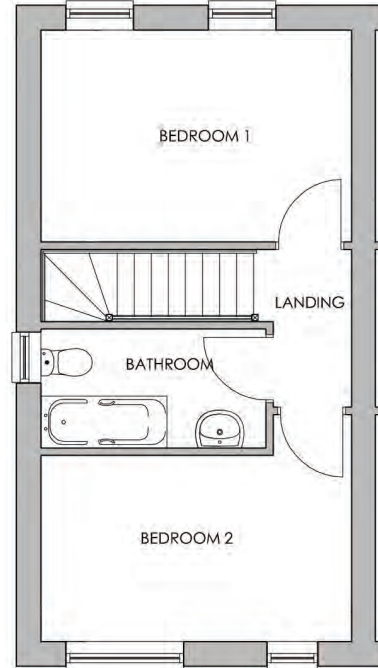

First Floor

The Prescott is an ideal starter home suited to individuals or couples, offering a contemporary layout for easy living.

With spacious Lounge/Dining Room, Kitchen and Cloakroom on the Ground floor along with Master bedroom, main bathroom and a second double bedroom large enough to accommodate a guest bed as well as space for home working.

GROUND FLOOR

Lounge	13'8" x 14' 4.17 x 3.27 m
Kitchen	9'10" x 9'4" 3 x 2.84 m
W.C.	3'6" x 5'9" 1.07 x 1.74 m

FIRST FLOOR

Master Bedroom	13'8" x 9'4" 4.17 x 2.84 m
Bedroom 2	13'8" x 8'3" 4.17 x 2.5 m
Bathroom	9'11" x 5'3" 3.02 x 1.6 m

www.severnhomes.co.uk

Disclaimer — The seller and its agents give notice to those who reads these particulars that: The particulars are prepared for the guidance only of prospective purchasers. They are intended to give a fair general description of the property but not to form an offer of contract. Any information, areas and measurements are approximate only. Rights are reserved to change the specification. The purpose of any imagery is to give a feel for the development, not an accurate description. External materials, finishes, landscaping etc may vary. Properties may also be built handed (mirror image). Please ask for further details.

monks

01743 361422
www.monks.co.uk